

Township of Leeds and the Thousand Islands

Notice of Road Closing and Sale

(Sections 34 of the Municipal Act 2001, S.O. 2001, c. 25)

TAKE NOTICE that the Council for the Corporation of the Township of Leeds and the Thousand Islands is considering a proposed sale of a portion of the unopened road allowance located in Lots 6 and 7, Concession 9, Former Township of Rear of Leeds and Lansdowne.

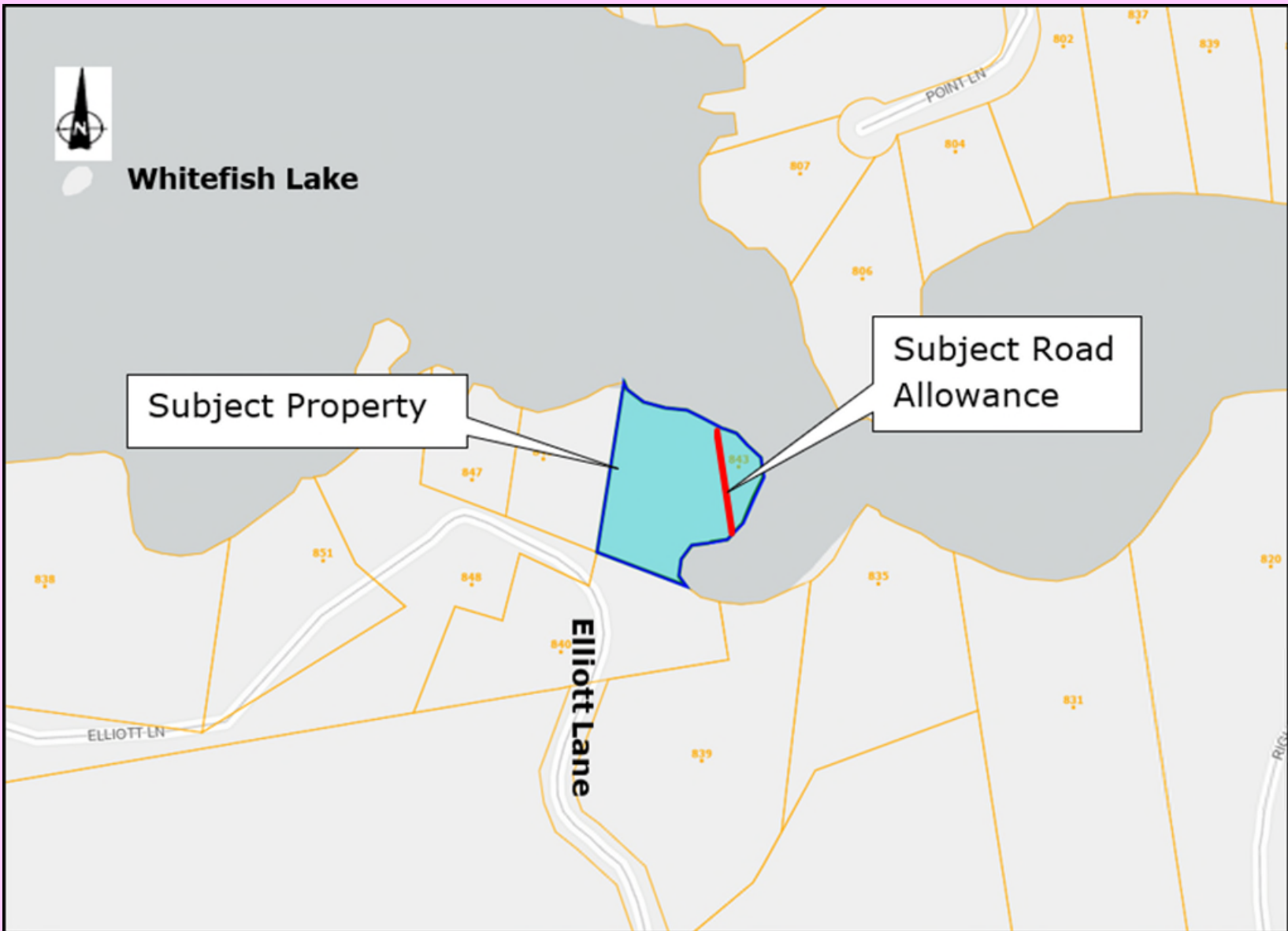

Key Map Demonstrating the location of the Road Allowance proposed to be closed.

The Township has received a request from the owners of the property located at 843 Elliott Lane seeking permission from Council to close a portion of the Municipal Road Allowance that travels through the property. Please see the attached Key Map for the location of the road allowance.

A report regarding this request will be presented to Council to consider on September 8, 2025 at 6:00 pm at the Township Office at 1233 Prince St, Lansdowne, ON. If you have any comments or questions or an interest in acquiring a portion of the road allowance subject to this request please submit written comments to or contact planning staff by August 28, 2025.

Comments can be submitted prior to the meeting to:
Office Location: 1233 Prince Street, Lansdowne, ON
Email: planningtechnician@townshipleeds.on.ca

Mailing Address:
Township of Leeds and the Thousand Islands
1233 Prince St, PO Box 280 Lansdowne, ON K0E 1L0

For further information concerning this application, please contact Kyle Peel, Planner at planner@townshipleeds.on.ca or 613-659-2415 x 205.